

**TYPICAL LIGHT TRAFFIC SECTION
WITH CONCRETE LID 30"W x 24"D**
SCALE: 1" = 1'-0"

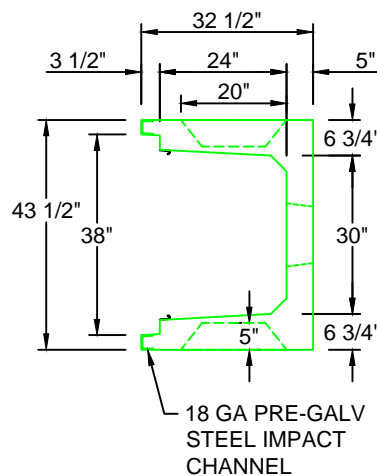
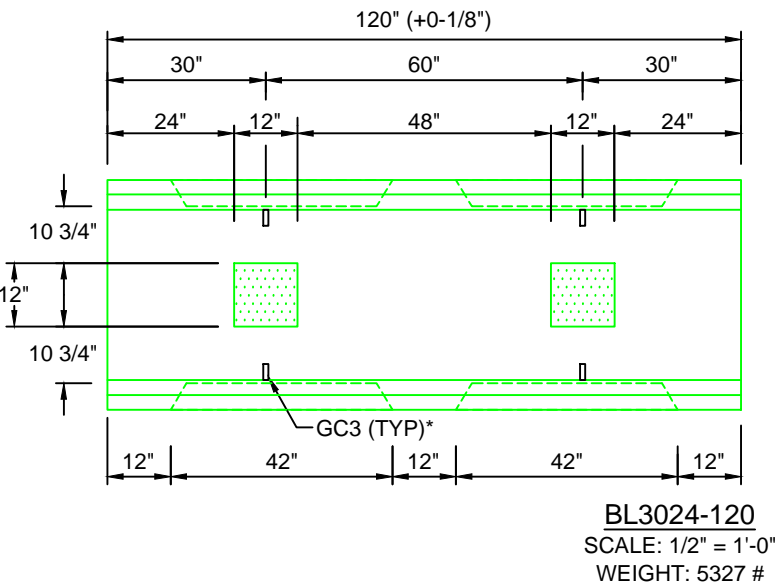

**H10 DESIGN
(16,000 LBS / AXLE)**

*GC3 (GROUND CLIPS) OPTIONAL

Trenwa Inc.		
1419 ALEXANDRIA PIKE FORT THOMAS, KY 41075 859-781-0831		
TYPICAL LIGHT TRAFFIC BASE, CONCRETE LID & SECTION FOR 30" WIDE x 24" DEEP TRENCH		
Date: 10/20/17	Dwg. No. BL3024-120	